

Model LF-X

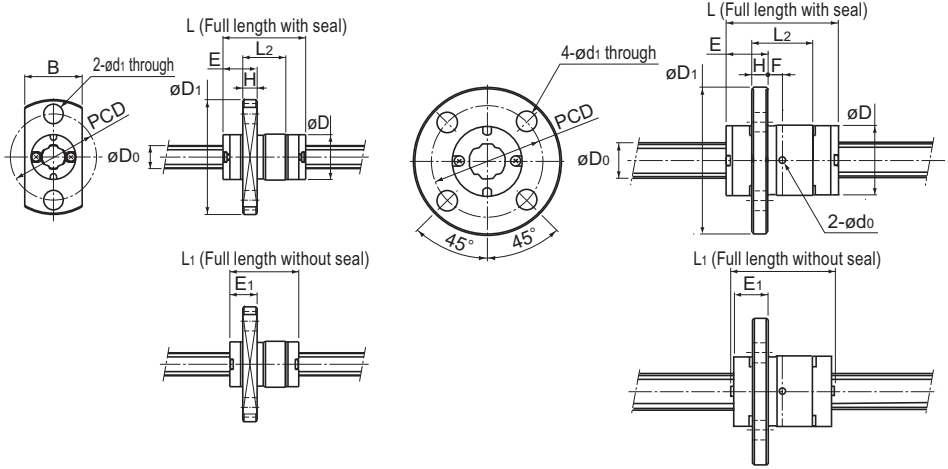

Model LF4X

Models LF5X to 8X

Model No.	Spline shaft diameter		Spline nut dimensions											
	D ₀ h7	Outer diameter		Length			Flange outer diameter		H	F	E	E ₁	Lubrication hole d ₀	PCD
		D	Tolerance	L (With seal)	L ₁ (Without seal)	L ₂	D ₁	B						
LF 4X	4	8	⁰ _{-0.009}	14.4	12	7.5	20	10	2.5	—	5.95	4.75	—	15
LF 5X LF 5XL	5	10	⁰ _{-0.009}	15 26	13.6 24.6	7.3 18.3	23	—	2.7	— 6.5	6.55	5.35	— 1	17
LF 6X LF 6XL	6	12	⁰ _{-0.011}	19 30	17.6 28.6	10.2 21.2	25	—	2.7	2.4 7.9	7.1	5.9	1	19
LF 8X LF 8XL	8	15	⁰ _{-0.011}	25 40	23.8 38.8	14.6 29.6	28	—	3.8	3.5 11	9	7.5	1.5	22
LF 10X	10	19	⁰ _{-0.013}	33	30.8	23.9	38	—	6	5.95	10.55	9.45	1.5	28
LF 13X	13	23	⁰ _{-0.013}	36	32.4	24	43	—	6	6	12	10.2	1.5	33
LF 16X	16	28	⁰ _{-0.013}	50	46.4	35.5	48	—	6	11.7	13.3	11.5	2	38
LF 20X	20	32	⁰ _{-0.016}	63	59	47.4	54	—	8	15.7	15.8	13.8	2	43
LF 25X	25	40	⁰ _{-0.016}	71	67	52.6	62	—	8	18.3	17.2	15.2	3	51
LF 30X	30	45	⁰ _{-0.016}	80	75.6	59.6	74	—	10	19.8	20.2	18	3	60

Model number coding

2 LF20X UU CL +700L P K

Model No.

Number of spline nuts on one shaft (no symbol for one nut)

Symbol for clearance in the rotational direction²

Contamination protection accessory symbol¹

Accuracy symbol³

Overall spline shaft length⁵ (in mm)

Symbol for spline shaft⁴

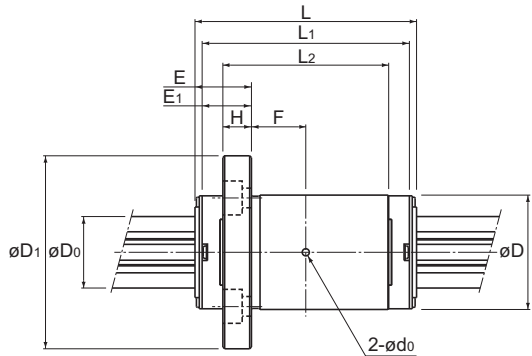
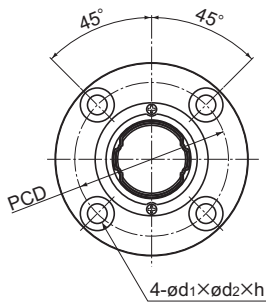

Models LF10X to 30X

Unit: mm

Mounting hole $d_1 \times d_2 \times h$		Basic torque rating		Basic load rating		Static permissible moment			Mass	
		C_T N·m	C_{OT} N·m	C kN	C_0 kN	M_{A1} N·m	M_{A2} (With seal) N·m	M_{A2} (Without seal) N·m	Spline nut g	Spline shaft kg/m
3.4 through		0.49	0.82	0.42	0.7	0.84	6.2	5	4.7	0.1
3.4 through		0.82 1.59	1.25 3.2	0.56 1.09	0.85 2.19	1.04 6.11	8.2 35.5	6.6 28.4	9.9 14.6	0.15
3.4 through		1.73 2.81	2.77 5.54	0.98 1.6	1.58 3.15	2.85 10.6	19 59.8	15.2 47.8	13.8 20.5	0.21
3.4 through		6 10.1	9.23 19.5	1.39 2.35	2.15 4.53	5.13 21.1	34.3 110.9	27.4 88.7	26.5 36.5	0.38
4.5×8×4.4		9.41	17.3	2.94	5.4	21.5	114	104	66	0.59
4.5×8×4.4		17.1	28.7	4.16	6.96	28.9	164	149	82	1.01
4.5×8×4.4		42.9	68.6	8.4	13.4	77.4	419	381	131	1.52
5.5×9.5×5.4		66.4	117	10.5	18.6	144	735	669	212	2.41
5.5×9.5×5.4		125	207	15.9	26.2	230	1,183	1,077	335	3.71
6.6×11×6.5		196	319	20.8	34	335	1,714	1,560	489	5.37